



St John's CofE Primary School Early Years Prospectus

“Shine like stars”





Your light must shine before people, so that they will see the good things you do and praise your Father in heaven.'
Matthew 5:16

It is a great joy to welcome you to St. John's Church of England Primary School. Choosing the right school for your child is one of the most important decisions you will make, and we are delighted to share with you what makes St. John's such a special place to begin their learning journey.

The Early Years are a time of wonder, discovery, and growth – the beginning of a journey that shapes each child's future. At St. John's, we believe every child is a unique and precious individual, created and loved by God.

Our vision, "Through God's love, we will flourish and develop our gifts in our nurturing community, as we strive to be an inspiration to all," lies at the heart of everything we do.

Our Early Years provision, known as Ruby Class, brings together both Nursery and Reception children in a safe, nurturing, and inspiring environment where children are encouraged to explore, play, and grow in confidence.

Through carefully planned experiences, we foster curiosity, creativity, and a lifelong love of learning.

Guided by our Christian values – respect, compassion, forgiveness, endurance, justice, and confidence – we aim to support every child's academic, emotional, and spiritual development.

We believe that the strongest foundations are built in partnership with parents and carers, and we value the vital role families play in a child's education. Together, we ensure children are equipped to thrive, both now and in the future.

At St. John's, children are encouraged to "shine like stars," and it is our privilege to help each one discover and share their light with the world.

With warmest regards,

Mrs Susan Notley
Headteacher



[Headteacher's Welcome](#)

[The Early Years Team](#)

[The Early Years at a Glance](#)

[A Day in Ruby Class: School Life](#)

[School lunches](#)

[Home Learning](#)

[School Uniform](#)

[Assessment and Progress](#)

[Breakfast and After School Clubs](#)

[Collective Worship](#)

[Safeguarding](#)

[Contact Information](#)



Susan Notley
Headteacher
SENCO



Joe Law
Deputy Headteacher



Lucy Gatward
Assistant Headteacher
Safeguarding Lead



Mimi Kelleher
EYFS Co-Ordinator
Ruby Class Teacher



Elena Dall'Aglio
Ruby Class LSA



Susie Dall'Aglio
Ruby Class LSA

The Early Years Team

As a Church of England school, our work is rooted in Christian values, which guide how we care for one another and shape the wider school community. Our senior leadership team plays an active and supportive role in Early Years, working closely with the team to maintain high standards, uphold our shared vision, and ensure every child receives the best possible start. Professional development is central to our culture, and our leaders are committed to continually strengthening the quality of teaching and care across the Foundation Stage and beyond.



Communication and Language

Children learn to build relationships, manage emotions, and develop confidence through group play, turn-taking games, role play and daily routines.



Personal, Social and Emotional Development

We develop listening, attention, and speaking skills through storytelling, conversation, songs, and language-rich play across all areas of the environment.



Physical Development

Through outdoor play, fine motor activities, and movement games, children strengthen coordination, control, and self-care skills essential for healthy development.



Literacy

Children develop early reading and writing through daily phonics, storytelling, mark-making and book talk. They explore language in meaningful ways across play, texts, role play and classroom routines.



Maths

We build number, shape, and measure skills through hands-on exploration. Counting, comparing, sorting and problem-solving are embedded in daily play using real-life contexts and engaging, practical activities.



Understanding the World

Children explore people, places, nature and time through stories, celebrations, hands-on discovery and outdoor learning that builds curiosity and understanding.



Expressive Arts and Design

We nurture creativity through music, art, dance and imaginative play, offering open-ended resources for children to express ideas and explore materials freely.

The EYFS at a Glance...

We believe that how children learn is just as important as what they learn. The Characteristics of Effective Learning, such as curiosity, concentration, resilience and creative thinking, are embedded in every part of our practice. Children are encouraged to explore their ideas, take risks in a safe environment, and reflect on their learning with growing independence. This foundation ensures that each child builds the confidence, motivation and deep understanding they need to thrive not only in Ruby Class, but throughout their journey at St. John's and beyond.

A morning in Ruby class

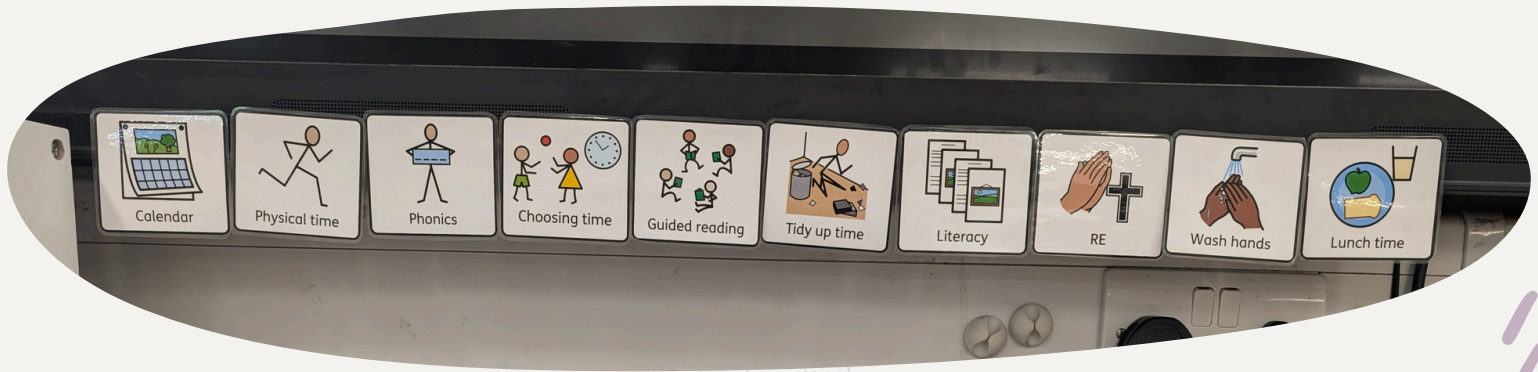

Each morning in Ruby Class begins with calm and purpose. Children are warmly welcomed by familiar adults and supported to check the visual timetable, helping them feel confident and ready for the day. We start the day together with our good morning songs and calendar, followed by movement-based activities to prepare body and mind for learning.



Phonics sessions follow the Read Write Inc program, with children grouped for focused, high-quality teaching that builds strong early reading skills. This leads into a rich period of child-led learning, with carefully planned indoor and outdoor areas offering a balance of open-ended play and purposeful activities linked to our topics. We also use our Rainbow Room for small group reading sessions in a calm, supportive space.

Later in the morning, we come together for a focused literacy session that develops children's skills in communication, language and writing. We finish the morning with collective worship and begin preparing for lunch with our friends.



School lunches

At St John's, school lunches are provided by Stir Food, offering a varied and nutritious menu that children enjoy. Each morning, children choose their lunch with staff support, with the current menu available on our school website for families to view together at home.

Mealtimes are treated as an important part of the school day. Staff sit with the children, modelling calm conversation, good manners and respectful table habits. Children are supported to eat with increasing independence, including the use of cutlery, which is gently practised throughout the week at our snack table.



Trying new foods is encouraged, and the colourful salad bar provides a wonderful opportunity to explore healthy choices. Milk and water are offered every day, and lunchtime becomes a time not just to eat, but to connect, grow, and enjoy being together.

An afternoon in Ruby class

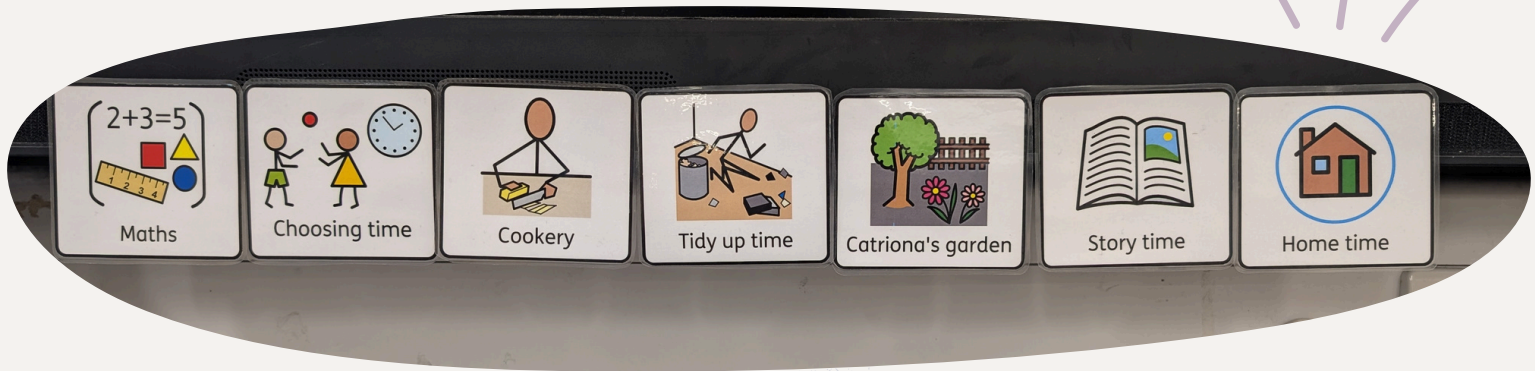

In Ruby Class, afternoons offer a carefully balanced mix of structured learning and meaningful exploration. We begin with a focused maths session, where children explore number, pattern, shape and measure through hands-on experiences. These sessions support mathematical thinking, problem-solving and confidence in reasoning.



Afterwards, children enjoy time to lead their own learning through purposeful play. The afternoon environment is calm, creative and designed to reflect their interests and developmental needs. We make full use of our wider school setting by visiting the library for quiet reflection, tending to Catriona's Garden, engaging in physical play in the hall, or using the playground as a space for collaboration and imagination. Throughout the week, children also take part in PE and music sessions with specialist teachers, enriching their physical and creative development.



Our afternoons are designed to inspire. They give children the space to wonder, to investigate, and to express themselves fully, laying the foundations for a confident, well-rounded and joyful approach to learning.

Collaboration between home and school

Strong, trusting relationships between home and school are key to a successful start to school life. We are committed to building a warm, open connection with every family.

Families are regularly invited to take part in school life, from open classroom sessions to special Church services. Parents are welcomed each week to our Friday celebration assembly, where we recognise children's achievements in front of the wider school community. Families also have opportunities to join us on local trips, creating shared experiences beyond the classroom.



Home-learning Activities



Family Workshops

We maintain clear and consistent communication. A member of the senior leadership team greets families each morning, and teachers are available at the classroom gate each afternoon. ClassDojo provides regular updates, while the school website, Latest News and newsletter help keep families connected and informed.

When school and home work closely together, children feel secure, motivated, and confident to thrive. That shared commitment is central to all we do.

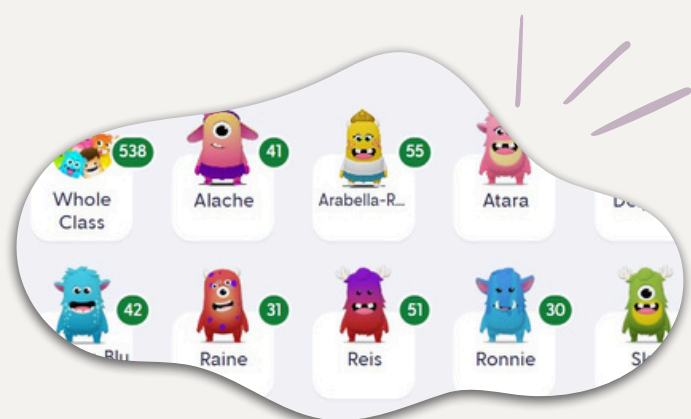

Regular communication

Home learning

Learning at home is just as important as at school. When children talk, play, read and explore with their families, they build the foundations for confident, curious learning that lasts a lifetime.

In Nursery, the focus is on connection and conversation. Sharing stories every day, enjoying wordless books, playing games and practising name writing all help children develop the language, imagination and motor skills they need to thrive. These simple routines make a powerful impact.

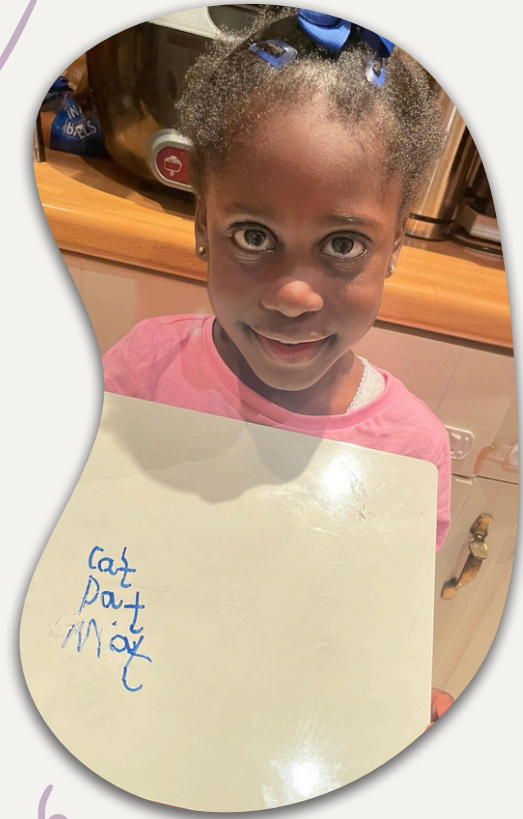

In Reception, home learning begins gently and grows as the year goes on. Children start with wordless books and one short task each week. As they learn their phonics, they bring home reading sheets, followed by books matched to their level and a weekly reading-for-pleasure book from our school library. We will also use online platforms like Oxford Owl eBooks and Maths and writing activities are also sent home each week.

Families are asked to read with their child every day for at least ten minutes. Homework tasks are supported with all the resources needed. Through ClassDojo, parents can share photos and news from home that help children talk about their lives and learning in school.



School Uniform

At St John's, our uniform is an important part of school life. It gives children a sense of identity and ensures they are dressed smartly and appropriately for learning.



Reception - Children wear the full school uniform each day, with PE kit on their designated PE day. A school book bag is also required.

Nursery - Our youngest children also wear school uniform. Families may choose either the main school uniform or the PE kit, depending on what their child can manage independently. A school book bag is also required.

We ask that all clothing is clearly labelled and suitable for active, hands-on learning. Full details of our school uniform are available on the school website.



Our uniform policy sets a clear standard from the very start, helping children to take pride in themselves and in belonging to St John's.

Assessment and Progress

At St. John's, we are ambitious for every child. Assessment is not simply about recording progress, it is about recognising each child's unique talents, celebrating their achievements, and ensuring they are always moving forward in their learning. Our full approach is explained in the school's Assessment Policy, available on our website.



In Ruby Class, our highly skilled Early Years team work with a very small class of Nursery and Reception children, giving exceptional individual attention. Each day, staff observe and interact with children during play, exploration, and focused activities, building a rich understanding of how they learn best. This knowledge allows us to plan precisely for each child, ensuring they are consistently challenged, supported, and inspired.

Progress is shared regularly with families through homework feedback, reading records, termly parent meetings, and the ongoing conversations that are a hallmark of our close-knit school community.

As the smallest school in Enfield, we offer something truly unique: every child is known, valued, and nurtured as an individual. Together with parents, we ensure each child leaves our Early Years with confidence, curiosity, and a strong foundation for future success.



Care Beyond the School Day

Breakfast Club provides a calm and welcoming start for children from Reception to Year 6. From 8.00am, pupils are welcomed in with a healthy and varied breakfast before enjoying activities with friends. It sets a positive tone for the day and ensures each child is ready to learn.



After-school clubs change termly to give children a wide variety of opportunities. From sport to creative and reflective activities, these sessions are both fun and enriching, encouraging well-rounded development while also complementing classroom learning. They play an important role in supporting children's spirituality, mental health, and overall wellbeing.

We are proud that over two-thirds of our pupils from Reception to Year 6 take part in at least one after-school club each term, showing how highly valued these opportunities are by our families.

Please note that Breakfast Club and after-school clubs are not currently available for Nursery pupils. Many parents, however, choose St. John's for the strength of our community and the exceptional care their children receive during the school day. Our extended hours may be limited, but the quality of care and breadth of opportunity are outstanding.

Collective Worship

Worship is at the heart of daily life at St. John's, and our youngest children are welcomed into this rhythm from their very first days in Ruby Class.

Each day begins and ends with simple prayers, with time for quiet reflection woven naturally into the morning, afternoon, and home-time routines. Ruby Class also enjoys daily Collective Worship, where stories, songs, and prayer invite children to reflect, give thanks, and grow in their understanding of faith.

We are fortunate to have regular visits from Mother Mitzi, who shares Bible stories and leads worship in a way that is engaging and meaningful for our youngest children. On Fridays, Ruby Class joins the whole school for a Celebration Assembly, a joyful time where achievements are recognised and the whole community gathers together in worship.



In Ruby Class, Collective Worship nurtures spirituality, inspires wonder, and helps every child feel part of our caring church school family.

Safeguarding

Your child's safety and wellbeing are our highest priority. We are committed to providing a secure, caring environment where every child can flourish.

St John's CE School is committed to the safeguarding of our pupils and staff



What to do if someone discloses to you: (A child may confide in any member of staff - or any other adult in the school, including helpers or visitors).

- Yours is a listening role. Do not interrupt the child if he or she is freely recalling a significant event. Any questions that may be needed to clarify what the child is saying should be framed in an open manner and not lead the child in any way.

Remember 'TED': tell me about . . . explain . . . describe . . .

- Make a note of the discussion as soon as is reasonably possible (but within 24 hours) to pass on to the Designated Teacher. The note should record the time, date, place and people who were present, as well as what was said – this may be used in any subsequent court proceedings.
- Do not give an undertaking of absolute confidentiality. The child should understand that, in order to keep them safe, you might need to tell someone. Resist the inclination to become the child's 'hero': the school procedures are in place to facilitate effective prosecution if this becomes necessary.
- Always inform the Designated Teacher; your responsibility in terms of referring concerns ends at this point. Even if you are not sure that it is a serious disclosure, it is still worth the referral as it is always better to be safe than sorry.

NSPCC Helpline 0800 800 5000

Designated Safeguarding Lead: Sue Notley
Deputy Designated: Joe Law
Deputy Designated: Lucy Gatward
Safeguarding Governor : Lilian Sanders



All staff are trained in safeguarding and child protection, and we follow rigorous procedures that meet statutory requirements. We also work closely with parents and external agencies to ensure children are supported and protected at all times.

Our full Safeguarding and Child Protection Policy can be found on the school website.

Safeguarding is everyone's responsibility — together we create a safe and nurturing school community.

Contact Information

We would be delighted to hear from you. If you would like to find out more about life at St. John's, arrange a visit, or have any questions about admissions, please get in touch with our school office.

St John's C.E. Primary
School Theobalds Park Road
Enfield
Middlesex
EN2 9BD

Tel: 020 8363 4709

Email: office@stjohnsprimarysch.org.uk

Telephone: 020 8363 4709

Fax: 020 8367 1284

Headteacher: Susan Notley
Deputy Headteacher: Joe Law
Assistant Headteacher: Lucy Gatward
SENCo: Susan Notley
Safeguarding Lead: Lucy Gatward
Chair of Governors: Lillian Sanders
Office Manager: Jane Flanagan

Our office team will be happy to help you or direct your enquiry to the right member of staff. We warmly encourage prospective families to arrange a visit as seeing Ruby Class and the wider school in action is the best way to experience the special community at St. John's.